



## VIC-EXTERIOR

### ASSEMBLY AND MOUNTING INSTRUCTIONS

UE-8711

#### GENERAL NOTES

- THIS LUMINAIRE IS SUITED FOR WET LOCATIONS.
- THIS LUMINAIRE IS UL LISTED. WHEN INSTALLING LUMINAIRE, CONFORM TO ALL APPLICABLE LOCAL ELECTRICAL CODES, ORDINANCES, AND THE NATIONAL ELECTRICAL CODE (NEC).
- FOR YOUR SAFETY AND PROPER OPERATION OF LUMINAIRE, READ AND UNDERSTAND ALL INSTRUCTIONS COMPLETELY BEFORE COMMENCING INSTALLATION OF THIS LUMINAIRE.
- CAREFULLY UNPACK THE LUMINAIRE AND INSPECT FOR DAMAGE.
- THIS PRODUCT IS RATED FOR TWO 60W MAX, TYPE B BULBS.
- SAVE THESE INSTRUCTIONS FOR FUTURE REFERENCE.

#### CAUTION

THIS PRODUCT SHOULD BE INSTALLED ONLY BY A LICENSED ELECTRICIAN.

#### WARNING

THE ELECTRICITY MUST BE TURNED OFF AT THE MAIN FUSE BOX BEFORE INSTALLING THIS LUMINAIRE. TURNING POWER OFF USING THE LIGHT SWITCH MAY NOT BE SUFFICIENT TO PREVENT ELECTRICAL SHOCK.

STANDARD

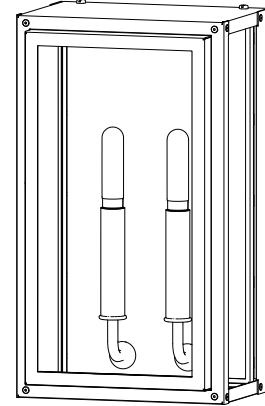

DARK SKY

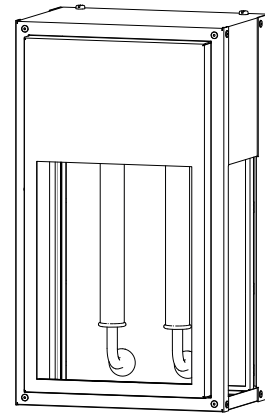

#### COMPONENTS PROVIDED FOR INSTALLATION

FIXTURE BODY	ELECTRICAL ARMS (X2)	FRONT GLASS	SIDE GLASS (X2)	INLAY (METAL OR GLASS)	BULBS (X2)	BULBS-TURTLE SAFE OPTION (X2)
NON-SHINY SPRING CLIP (X2)	SHINY SPRING CLIP (X2)	(X4) WALL ANCHORS	MOUNTING SCREWS (X4)	WIRE NUTS	HEX WRENCH	HEX NUTS AND WASHERS



## VIC-EXTERIOR

### ASSEMBLY AND MOUNTING INSTRUCTIONS

UE-8711

O-RING (X2)

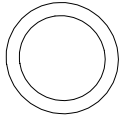

JUNCTION BOX  
SCREW (X2)



### GLASS INSTALL INSTRUCTIONS

#### STEP 1

REMOVE 4 PANHEAD SCREWS FROM FIXTURE TOP AND BOTTOM AND SET ASIDE. SEPARATE CAGE FROM BACK PLATE.

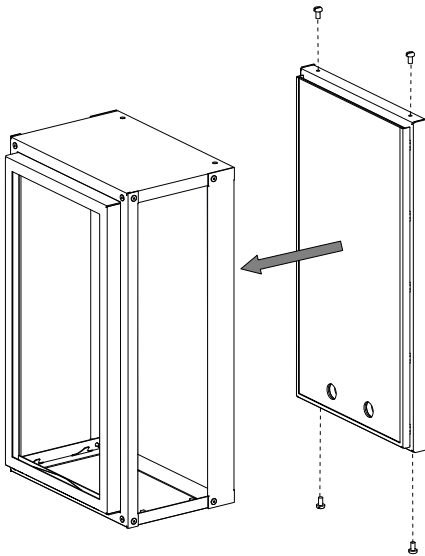

#### STEP 2

CAREFULLY INSTALL FRONT GLASS INTO CAGE WITH NON-SHINY SPRING CLIPS TO SECURE IN PLACE.

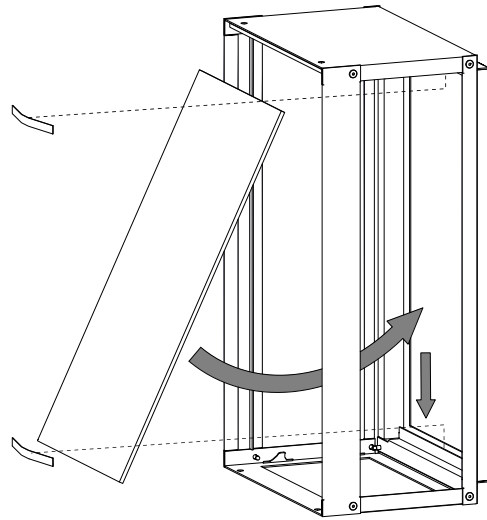

#### STEP 3

INSTALL SIDE GLASS PANELS AND FOLD TABS OVER TO SECURE IN PLACE.

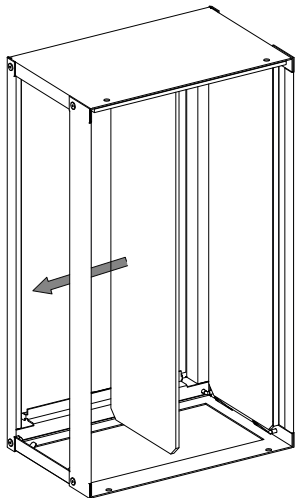

#### STEP 4

FOR BACK PLATE, LOOSEN THE TWO SET SCREWS AT THE BOTTOM OF THE FIXTURE USING THE PROVIDED HEX WRENCH. REMOVE THE MOUNTING PLATE FROM THE BACK OF THE FIXTURE AND SET ASIDE.

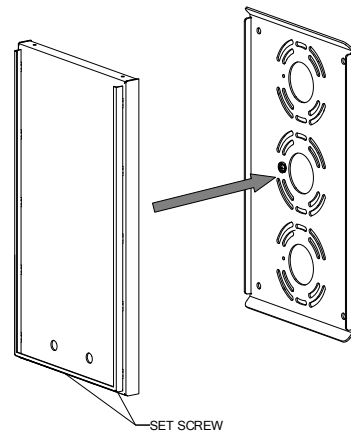



## VIC-EXTERIOR

### ASSEMBLY AND MOUNTING INSTRUCTIONS

UE-8711

#### STEP 5

SLIDE INLAY INTO PLACE WITH SHINY SPRING CLIPS.

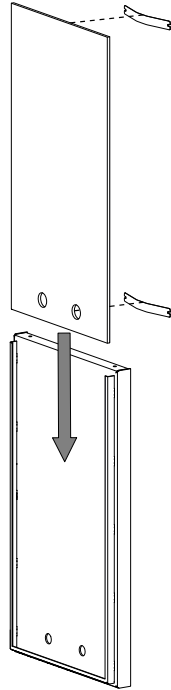

#### STEP 6

ATTACH ELECTRICAL ARMS OVER INLAY WITH O-RINGS, HEX NUTS AND WASHERS. ENSURE THAT O-RING SITS BETWEEN ELECTRICAL ARM AND INLAY. BE CAREFUL NOT TO OVERTIGHTEN WITH GLASS INLAY OR IT MAY BREAK.

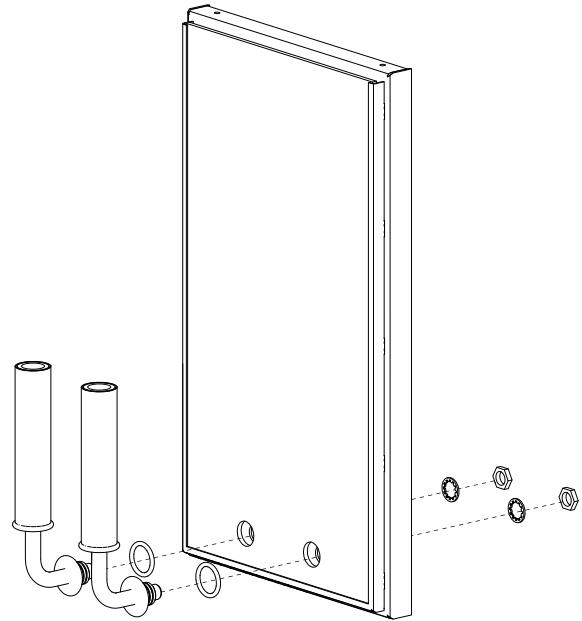

### MOUNTING INSTRUCTIONS – ONE PERSON INSTALL

#### STEP 1

SHUT OFF THE MAIN ELECTRICAL SUPPLY TO THE JUNCTION BOX FROM THE FUSE BOX/CIRCUIT BREAKER. TURNING POWER OFF AT THE SWITCH IS NOT SUFFICIENT.

#### STEP 2

LOCATE JUNCTION BOX AND PULL HOUSE SUPPLY CIRCUIT WIRING THROUGH THE WIRE-WAY OF THE MOUNTING PLATE. ATTACH THE MOUNTING PLATE TO THE JUNCTION BOX USING THE JUNCTION BOX SCREWS AND DIRECTLY TO THE WALL WITH THE WALL ANCHORS AND MOUNTING SCREWS PROVIDED. IT IS IMPORTANT TO CHECK LEVEL ON THE MOUNTING PLATE.

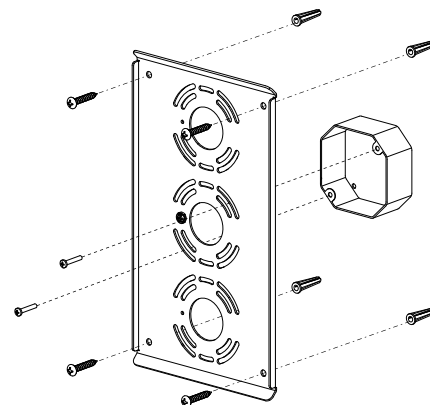



## VIC-EXTERIOR

### ASSEMBLY AND MOUNTING INSTRUCTIONS

UE-8711

#### STEP 3

USING THE WIRE NUTS PROVIDED, MAKE ELECTRICAL CONNECTIONS BY FOLLOWING THE ELECTRICAL CONFIGURATION TABLE BELOW. ENSURE THAT ALL ELECTRICAL CONNECTIONS ARE WRAPPED WITH UL-LISTED ELECTRICAL TAPE.

#### STEP 4

ATTACH BACKPLATE TO THE WALL BY SLIPPING IT OVER THE MOUNTING PLATE AND TIGHTENING THE TWO SET SCREWS AT THE BOTTOM OF THE FIXTURE. BE CAREFUL TO AVOID SCRATCHING THE FINISH ON THE FIXTURE.

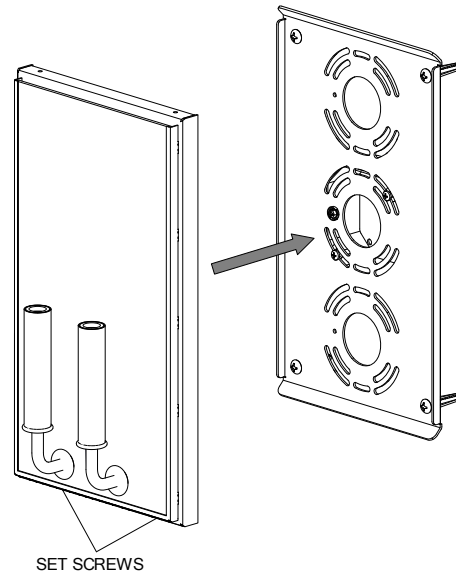

#### STEP 5

INSTALL BULBS. RETURN POWER TO CIRCUIT. CONFIRM PROPER OPERATION OF FIXTURE.

IF INSTALLING IN A WET LOCATION, RUN A SMALL BEAD OF SEALANT AROUND THE PERIMETER OF THE BACKPLATE TO PREVENT WATER FROM REACHING THE WIRE CONNECTIONS.

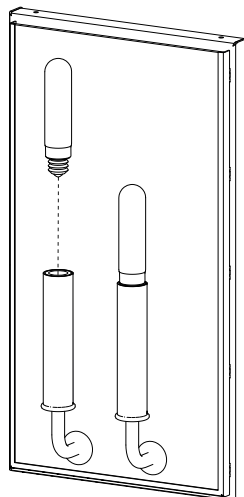

#### STEP 6

SLIDE CAGE OVER BACKPLATE AND REATTACH PANHEAD SCREWS TO SECURE IN PLACE.

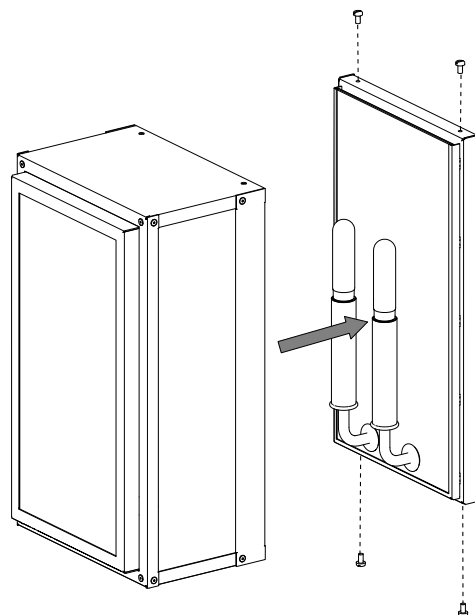



## VIC-EXTERIOR

### ASSEMBLY AND MOUNTING INSTRUCTIONS

UE-8711

#### ELECTRICAL CONFIGURATION TABLE

---

FROM HOME	FROM LUMINAIRE
CONNECT BLACK OR RED (HOT) HOUSE SUPPLY CIRCUIT WIRE TO:	LUMINAIRE ROUND/BLACK WIRE (HOT)
CONNECT WHITE (NEUTRAL) HOUSE SUPPLY CIRCUIT WIRE TO:	LUMINAIRE RIBBED/WHITE WIRE (NEUTRAL)
CONNECT GREEN INSULATED OR BARE COPPER (GROUND -) HOUSE SUPPLY CIRCUIT WIRE AND LUMINAIRE BARE STRANDED WIRE (GROUND -) TO GREEN GROUND SCREW ON CROSSBAR.	

**GENERAL NOTE:** USE UL LISTED WIRE NUTS FOR THE  
WIRING CONNECTIONS IN THIS LUMINAIRE. WRAP WIRE  
NUT CONNECTIONS WITH UL LISTED ELECTRICAL TAPE.

FOR QUESTIONS, PLEASE CONTACT CLIENT SERVICES AT:  
843.723.8140 OR [INFO@URBANELECTRICCO.COM](mailto:INFO@URBANELECTRICCO.COM)