



VESSEL

ASSEMBLY AND MOUNTING INSTRUCTIONS

UE-2436

GENERAL NOTES

- THIS LUMINAIRE IS SUITED FOR DAMP LOCATIONS.
- WHEN INSTALLING LUMINAIRE, CONFORM TO ALL APPLICABLE LOCAL ELECTRICAL CODES, ORDINANCES, AND THE NATIONAL ELECTRICAL CODE (NEC).
- FOR YOUR SAFETY AND PROPER OPERATION OF LUMINAIRE, READ AND UNDERSTAND ALL INSTRUCTIONS COMPLETELY BEFORE COMMENCING INSTALLATION OF THIS LUMINAIRE.
- CAREFULLY UNPACK THE LUMINAIRE AND INSPECT FOR DAMAGE.
- THIS FIXTURE IS RATED FOR THREE 60W MAX, TYPE B BULBS.
- SAVE THESE INSTRUCTIONS FOR FUTURE REFERENCE.

CAUTION

- THIS PRODUCT SHOULD BE INSTALLED ONLY BY A LICENSED ELECTRICIAN.

WARNING

THE ELECTRICITY MUST BE TURNED OFF AT THE MAIN FUSE BOX BEFORE INSTALLING THIS LUMINAIRE. TURNING POWER OFF USING THE LIGHT SWITCH MAY NOT BE SUFFICIENT TO PREVENT ELECTRICAL SHOCK.

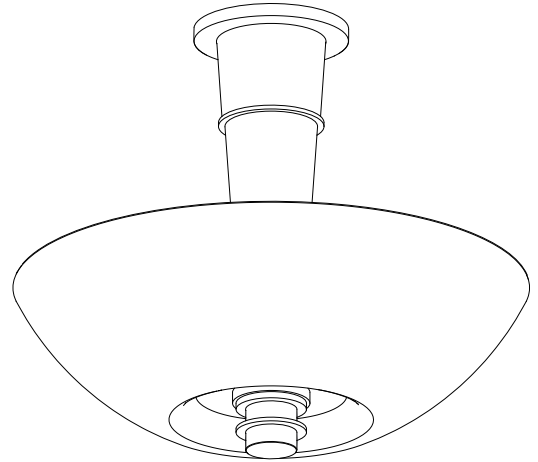

COMPONENTS PROVIDED FOR INSTALLATION

FIXTURE BODY	MOUNTING ASSEMBLY	CAP	GLASS
WIRE NUTS (X3)	HEX WRENCH	JUNCTION BOX SCREWS (X2)	BULB (X3)



VESSEL

ASSEMBLY AND MOUNTING INSTRUCTIONS

UE-2436

MOUNTING INSTRUCTIONS – 2 PERSON INSTALLATION

STEP 1

SHUT OFF THE MAIN ELECTRICAL SUPPLY TO THE JUNCTION BOX FROM THE FUSE BOX/CIRCUIT BREAKER. TURNING POWER OFF AT THE SWITCH IS NOT SUFFICIENT.

STEP 2

LOCATE JUNCTION BOX. ATTACH MOUNTING ASSEMBLY TO JUNCTION BOX WITH JUNCTION BOX SCREWS. USE PROVIDED HEXWRENCH TO LOOSEN SET SCREW IN BOTTOM COUPLER ASSEMBLY AND SET ASIDE.

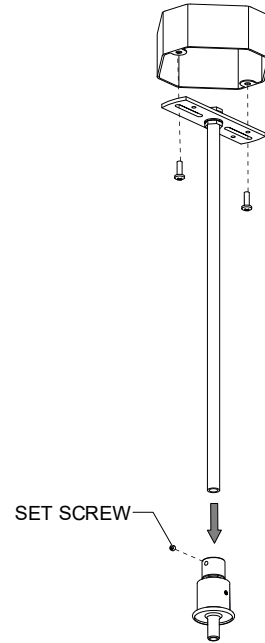

STEP 3

LIFT FIXTURE TO CEILING. USING THE WIRE NUTS PROVIDED, MAKE ELECTRICAL CONNECTIONS BY FOLLOWING THE ELECTRICAL CONFIGURATION TABLE PROVIDED. ENSURE THAT ALL ELECTRICAL CONNECTIONS ARE WRAPPED WITH UL-LISTED ELECTRICAL TAPE.

IMPORTANT: NEVER ALLOW FIXTURE TO HANG FROM ELECTRICAL CONNECTIONS. WEIGHT OF FIXTURE CAN ONLY BE SUPPORTED BY THE MOUNTING ASSEMBLY.

STEP 4

SECURE FIXTURE BODY IN PLACE BY REATTACHING BOTTOM COUPLER ASSEMBLY TO THREADED NIP AND TIGHTEN SET SCREW WITH HEX WRENCH.

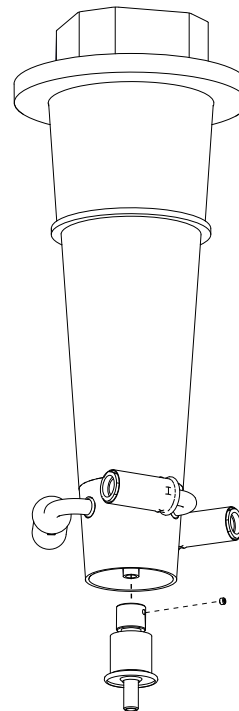



VESSEL ASSEMBLY AND MOUNTING INSTRUCTIONS

UE-2436

STEP 5

INSTALL BULBS. RESTORE POWER TO THE CIRCUIT. CONFIRM PROPER OPERATION OF FIXTURE.

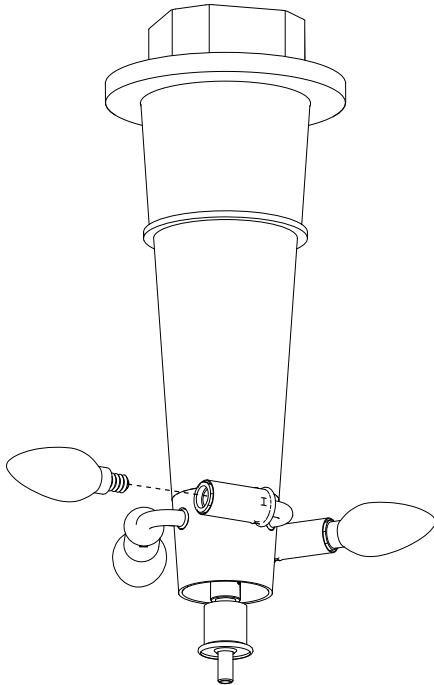

STEP 6

LIFT GLASS BOWL TO FIXTURE AND SLIP CENTER HOLE OVER BOTTOM THREADS. SECURE IN PLACE WITH CAP.

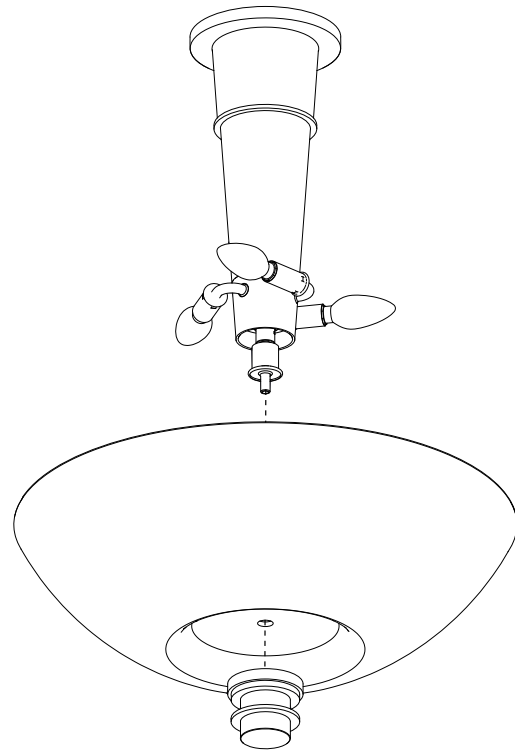

ELECTRICAL CONFIGURATION TABLE

FROM HOME	FROM LUMINAIRE
CONNECT BLACK OR RED (HOT) HOUSE SUPPLY CIRCUIT WIRE TO:	LUMINAIRE ROUND/BLACK WIRE (HOT)
CONNECT WHITE (NEUTRAL) HOUSE SUPPLY CIRCUIT WIRE TO:	LUMINAIRE RIBBED/WHITE WIRE (NEUTRAL)
CONNECT GREEN INSULATED OR BARE COPPER (GROUND -) HOUSE SUPPLY CIRCUIT WIRE AND LUMINAIRE BARE STRANDED WIRE (GROUND -) TO GREEN GROUND SCREW ON CROSSBAR.	

GENERAL NOTE: USE UL LISTED WIRE NUTS FOR THE WIRING CONNECTIONS IN THIS LUMINAIRE. WRAP WIRE NUT CONNECTIONS WITH UL LISTED ELECTRICAL TAPE.

FOR QUESTIONS, PLEASE CONTACT CLIENT SERVICES AT:

843.723.8140 OR INFO@URBANELECTRICCO.COM