



## STEM - HARDWIRED ASSEMBLY AND MOUNTING INSTRUCTIONS

UE-2446

### GENERAL NOTES

- THIS LUMINAIRE IS SUITED FOR DAMP LOCATIONS.
- THIS LUMINAIRE IS UL LISTED. WHEN INSTALLING LUMINAIRE, CONFORM TO ALL APPLICABLE LOCAL ELECTRICAL CODES, ORDINANCES, AND THE NATIONAL ELECTRICAL CODE (NEC).
- FOR YOUR SAFETY AND PROPER OPERATION OF LUMINAIRE, READ AND UNDERSTAND ALL INSTRUCTIONS COMPLETELY BEFORE COMMENCING INSTALLATION OF THIS LUMINAIRE.
- CAREFULLY UNPACK THE LUMINAIRE AND INSPECT FOR DAMAGE.
- THIS PRODUCT IS RATED FOR ONE 60W MAX, TYPE A BULB.
- SAVE THESE INSTRUCTIONS FOR FUTURE REFERENCE.

#### CAUTION

- THIS PRODUCT SHOULD BE INSTALLED ONLY BY A LICENSED ELECTRICIAN.
- THIS FIXTURE WEIGHS APPROXIMATELY 6 LBS.

#### WARNING

THE ELECTRICITY MUST BE TURNED OFF AT THE MAIN FUSE BOX BEFORE INSTALLING THIS LUMINAIRE. TURNING POWER OFF USING THE LIGHT SWITCH MAY NOT BE SUFFICIENT TO PREVENT ELECTRICAL SHOCK.

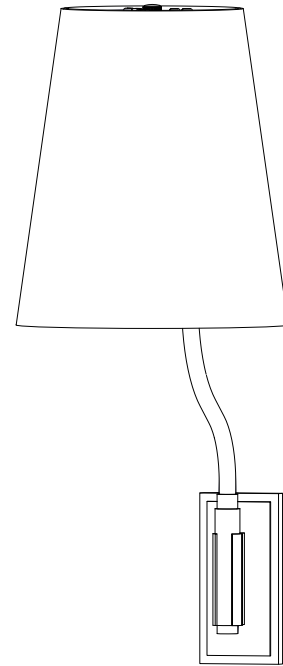

### COMPONENTS PROVIDED FOR INSTALLATION

FIXTURE BODY	SHADE SPIDER	DIFFUSER CLIP (X3)	PAN HEAD SCREWS (X6)	MOUNTING PLATE	SHADE
DIFFUSER	HOUSEHOLD BULB	JUNCTION BOX SCREWS (X2)	WIRE NUTS (X2)	BACK PLATE EXTENSION (OPTIONAL)	WALL ANCHORS (X2 EACH) (OPTIONAL)
					MOUNTING SCREWS (X2) (OPTIONAL)



## STEM - HARDWIRED ASSEMBLY AND MOUNTING INSTRUCTIONS

UE-2446

### MOUNTING INSTRUCTIONS

#### STEP 1

SHUT OFF THE MAIN ELECTRICAL SUPPLY TO THE JUNCTION BOX FROM THE FUSE BOX/CIRCUIT BREAKER. TURNING POWER OFF AT THE SWITCH IS NOT SUFFICIENT.

#### STEP 2

USING THE PROVIDED HEX WRENCH, LOOSEN SET SCREWS AT THE BOTTOM OF THE FIXTURE ENOUGH TO REMOVE THE MOUNTING PLATE FROM THE BACK OF THE FIXTURE. PLACE THE FIXTURE ASIDE.

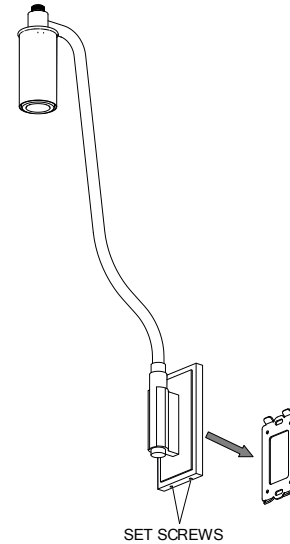

#### STEP 3

PULL HOUSE SUPPLY CIRCUIT WIRING THROUGH THE WIRE-WAY OF THE MOUNTING PLATE. ATTACH THE MOUNTING PLATE TO THE JUNCTION BOX USING THE JUNCTION BOX SCREWS. ENSURE MOUNTING PLATE IS LEVEL.

FOR BACKPLATE EXTENSION OPTION (OCTAGONAL JUNCTION BOX): ALIGN MOUNTING ASSEMBLY WITH JUNCTION BOX AND MARK HOLES FOR WALL ANCHORS. DRILL HOLES AND INSTALL APPROPRIATE ANCHORS. ATTACH ASSEMBLY TO WALL WITH MOUNTING SCREWS.

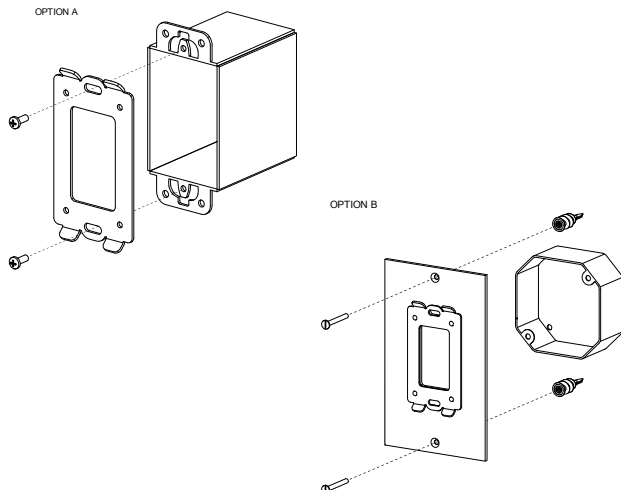

#### STEP 4

USING THE WIRE NUTS PROVIDED, MAKE ELECTRICAL CONNECTIONS BY FOLLOWING THE ELECTRICAL CONFIGURATION TABLE BELOW. ENSURE THAT ALL ELECTRICAL CONNECTIONS ARE WRAPPED WITH UL-LISTED ELECTRICAL TAPE.



## STEM - HARDWIRED ASSEMBLY AND MOUNTING INSTRUCTIONS

UE-2446

### STEP 5

ATTACH THE FIXTURE TO THE WALL BY SLIPPING THE FIXTURE OVER THE MOUNTING PLATE AND TIGHTENING THE SET SCREW AT THE BOTTOM OF THE FIXTURE. BE CAREFUL TO AVOID SCRATCHING THE FINISH ON THE FIXTURE.

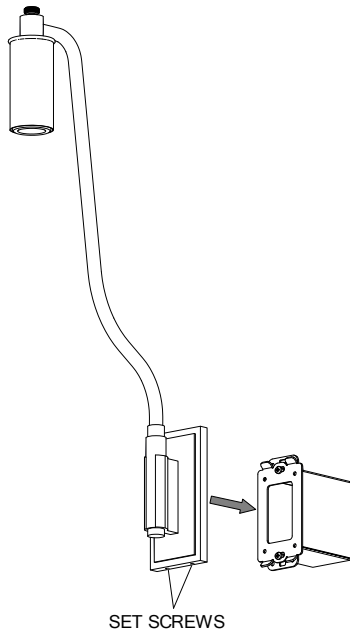

### STEP 6

ASSEMBLE DIFFUSER CLIPS TO SHADE SPIDER WITH PAN HEAD SCREWS

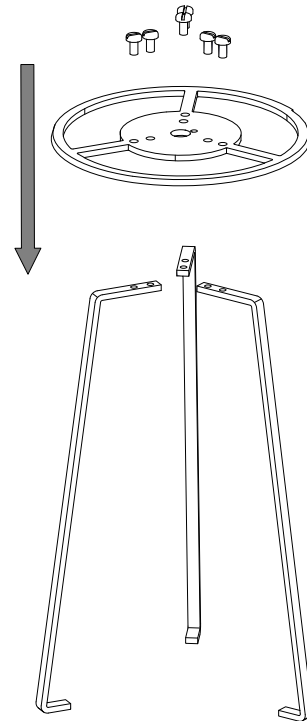

### STEP 7

REMOVE CAP ON TOP OF FIXTURE ARM, SLIP CENTER HOLE OF SPIDER ASSEMBLY OVER NIP AND REATTACH CAP.

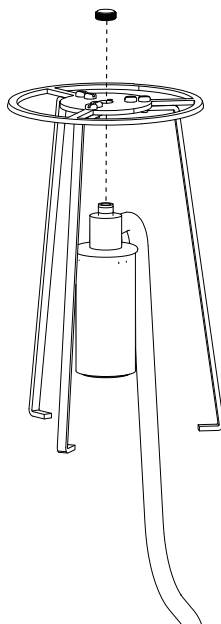

### STEP 8

INSTALL THE LIGHT BULB IN THE FIXTURE SOCKET AND RESTORE POWER TO THE FIXTURE. CONFIRM PROPER OPERATION OF THE LIGHT FIXTURE.

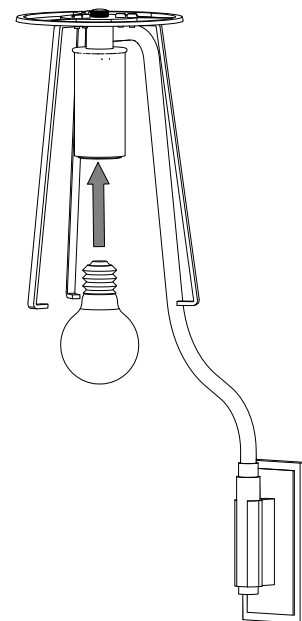



## STEM - HARDWIRED ASSEMBLY AND MOUNTING INSTRUCTIONS

UE-2446

### STEP 9

INSTALL DIFFUSER BY PUSHING ONE CLIP OUT TO ALLOW CLEARANCE OF DIFFUSER. DIFFUSER SHOULD REST ON BOTTOM TABS OF ALL THREE CLIPS.

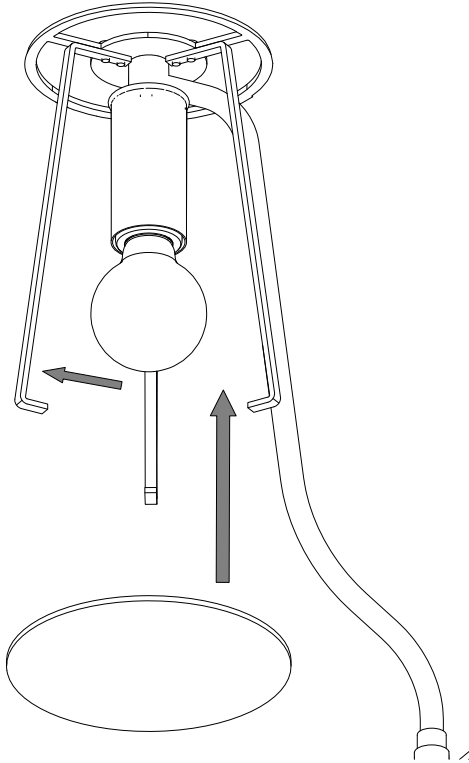

### STEP 10

INSTALL SHADE. TOP LIP OF SHADE SHOULD REST ON TOP OF SHADE SPIDER.

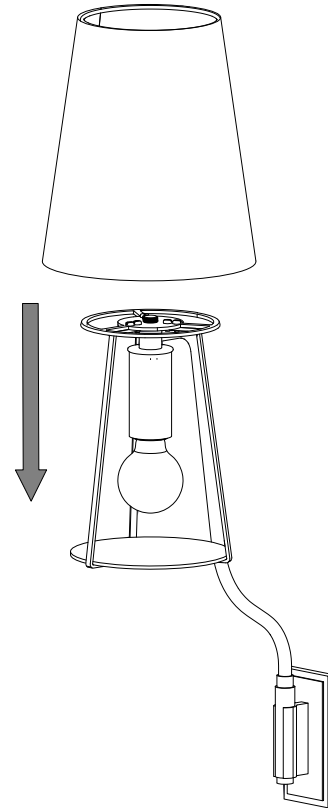

### ELECTRICAL CONFIGURATION TABLE (FOR HARDWIRED ONLY)

FROM HOME	FROM LUMINAIRE
CONNECT BLACK OR RED (HOT) HOUSE SUPPLY CIRCUIT WIRE TO:	LUMINAIRE ROUND/BLACK WIRE (HOT)
CONNECT WHITE (NEUTRAL) HOUSE SUPPLY CIRCUIT WIRE TO:	LUMINAIRE RIBBED/WHITE WIRE (NEUTRAL)
CONNECT GREEN INSULATED OR BARE COPPER (GROUND -) HOUSE SUPPLY CIRCUIT WIRE AND LUMINAIRE BARE STRANDED WIRE (GROUND -) TO GREEN GROUND SCREW ON MOUNTING PLATE.	

**GENERAL NOTE:** USE UL LISTED WIRE NUTS FOR THE WIRING CONNECTIONS IN THIS LUMINAIRE. WRAP WIRE NUT CONNECTIONS WITH UL LISTED ELECTRICAL TAPE.

FOR QUESTIONS, PLEASE CONTACT CLIENT SERVICES AT:  
843.723.8140 OR [INFO@URBANELECTRICCO.COM](mailto:INFO@URBANELECTRICCO.COM)