



SCOOP

ASSEMBLY AND MOUNTING INSTRUCTIONS

MA-1650

GENERAL NOTES

- THIS LUMINAIRE IS SUITED FOR DAMP LOCATIONS.
- THIS LUMINAIRE IS UL LISTED. WHEN INSTALLING LUMINAIRE, CONFORM TO ALL APPLICABLE LOCAL ELECTRICAL CODES, ORDINANCES, AND THE NATIONAL ELECTRICAL CODE (NEC).
- FOR YOUR SAFETY AND PROPER OPERATION OF LUMINAIRE, READ AND UNDERSTAND ALL INSTRUCTIONS COMPLETELY BEFORE COMMENCING INSTALLATION OF THIS LUMINAIRE.
- CAREFULLY UNPACK THE LUMINAIRE AND INSPECT FOR DAMAGE.
- THIS PRODUCT IS RATED FOR ONE 60W MAX, TYPE A BULB.
- SAVE THESE INSTRUCTIONS FOR FUTURE REFERENCE.

CAUTION

THIS PRODUCT SHOULD BE INSTALLED ONLY BY A LICENSED ELECTRICIAN.
PLEASE WEAR GLOVES TO PROTECT THE FINISH OF THE FIXTURE.

WARNING

THE ELECTRICITY MUST BE TURNED OFF AT THE MAIN FUSE BOX BEFORE INSTALLING THIS LUMINAIRE. TURNING POWER OFF USING THE LIGHT SWITCH MAY NOT BE SUFFICIENT TO PREVENT ELECTRICAL SHOCK.

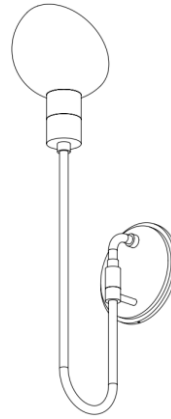

METAL SHADE
(UPWARD
ORIENTAION)

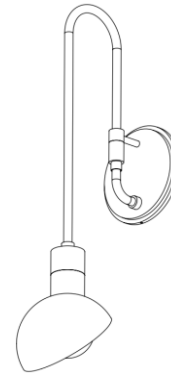

METAL SHADE
(DOWNWARD
ORIENTAION)

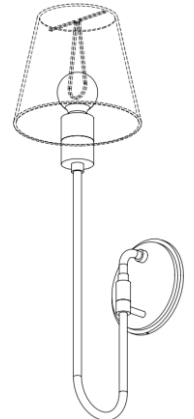

PAPER SHADE

COMPONENTS PROVIDED FOR INSTALLATION

<p>FIXTURE BODY</p>	<p>MOUNTING PLATE</p>	<p>METAL SHADE (FOR METAL SHADE FIXTURE)</p>	<p>(2X) MACHINE SCREWS (FOR METAL SHADE FIXTURE)</p>	<p>3" BULB (FOR METAL SHADE FIXTURE)</p>
<p>PAPER SHADE (FOR PAPER SHADE FIXTURE)</p>	<p>HOUSEHOLD LIGHTBULB (FOR PAPER SHADE FIXTURE)</p>	<p>WIRE NUTS</p>	<p>HEX WRENCH</p>	



SCOOP

ASSEMBLY AND MOUNTING INSTRUCTIONS

MA-1650

MOUNTING INSTRUCTIONS

STEP 1

SHUT OFF THE MAIN ELECTRICAL SUPPLY TO THE JUNCTION BOX FROM THE FUSE BOX/CIRCUIT BREAKER. TURNING POWER OFF AT THE SWITCH IS NOT SUFFICIENT.

STEP 2

FOR METAL SHADE: ENSURING THAT THE METAL SHADE OPENING FACES TOWARDS THE WALL, ATTACH THE METAL SHADE TO THE FIXTURE BODY USING THE TWO PROVIDED MACHINE SCREWS.

THE METAL SHADE FIXTURE CAN BE MOUNTING WITH THE ARM FACING UP OR DOWN.

FOR PAPER SHADE: SKIP STEP 2

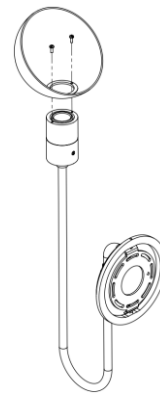

STEP 3

USING THE PROVIDED HEX WRENCH, LOOSEN THE SET SCREWS AT THE TOP AND BOTTOM OF THE FIXTURE ENOUGH TO REMOVE THE MOUNTING PLATE FROM THE BACK OF THE FIXTURE. PLACE THE FIXTURE ASIDE.

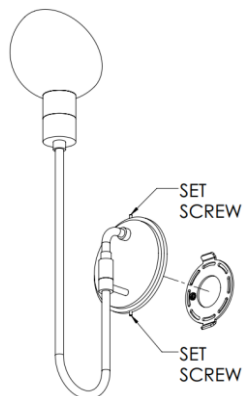

STEP 4

PULL HOUSE SUPPLY CIRCUIT WIRING THROUGH THE WIRE-WAY OF THE MOUNTING PLATE. ATTACH THE MOUNTING PLATE TO THE JUNCTION BOX USING THE JUNCTION BOX SCREWS. IT IS IMPORTANT TO CHECK LEVEL ON THE MOUNTING PLATE.

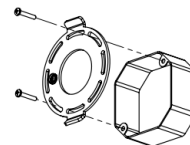



SCOOP ASSEMBLY AND MOUNTING INSTRUCTIONS

MA-1650

STEP 5

USING THE WIRE NUTS PROVIDED, MAKE ELECTRICAL CONNECTIONS BY FOLLOWING THE ELECTRICAL CONFIGURATION TABLE BELOW. ENSURE THAT ALL ELECTRICAL CONNECTIONS ARE WRAPPED WITH UL-LISTED ELECTRICAL TAPE.

STEP 6

ATTACH THE FIXTURE TO THE WALL BY SLIPPING THE FIXTURE OVER THE MOUNTING PLATE AND TIGHTENING THE SET SCREWS AT THE TOP AND BOTTOM OF THE FIXTURE. BE CAREFUL TO AVOID SCRATCHING THE FINISH OF THE FIXTURE.

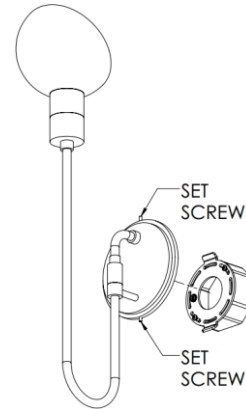

STEP 7

INSTALL THE LIGHT BULB IN THE FIXTURE SOCKET AND RESTORE POWER TO THE FIXTURE. CONFIRM PROPER OPERATION OF THE LIGHT FIXTURE.

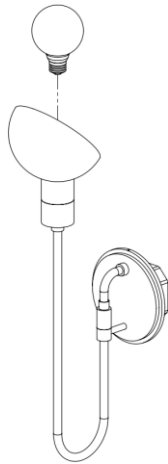



SCOOP

ASSEMBLY AND MOUNTING INSTRUCTIONS

MA-1650

ELECTRICAL CONFIGURATION TABLE

FROM HOME	FROM LUMINAIRE
CONNECT BLACK OR RED (HOT) HOUSE SUPPLY CIRCUIT WIRE TO:	LUMINAIRE ROUND/BLACK WIRE (HOT)
CONNECT WHITE (NEUTRAL) HOUSE SUPPLY CIRCUIT WIRE TO:	LUMINAIRE RIBBED/WHITE WIRE (NEUTRAL)
CONNECT GREEN INSULATED OR BARE COPPER (GROUND -) HOUSE SUPPLY CIRCUIT WIRE AND LUMINAIRE BARE STRANDED WIRE (GROUND -) TO GREEN GROUND SCREW ON MOUNTING PLATE	

GENERAL NOTE: USE UL LISTED WIRE NUTS FOR THE
WIRING CONNECTIONS IN THIS LUMINAIRE. WRAP WIRE
NUT CONNECTIONS WITH UL LISTED ELECTRICAL TAPE.

FOR QUESTIONS, PLEASE CONTACT CLIENT SERVICES
AT:

843.723.8140 OR INFO@URBANELECTRICCO.COM