



SAILOR V.2

ASSEMBLY AND MOUNTING INSTRUCTIONS

UE-2401

GENERAL NOTES

- THIS LUMINAIRE IS SUITED FOR DAMP LOCATIONS.
- THIS LUMINAIRE IS UL LISTED. WHEN INSTALLING LUMINAIRE, CONFORM TO ALL APPLICABLE LOCAL ELECTRICAL CODES, ORDINANCES, AND THE NATIONAL ELECTRICAL CODE (NEC).
- FOR YOUR SAFETY AND PROPER OPERATION OF LUMINAIRE, READ AND UNDERSTAND ALL INSTRUCTIONS COMPLETELY BEFORE COMMENCING INSTALLATION OF THIS LUMINAIRE.
- CAREFULLY UNPACK THE LUMINAIRE AND INSPECT FOR DAMAGE.
- THIS PRODUCT IS RATED FOR ONE 40W TYPE B BULB
- SAVE THESE INSTRUCTIONS FOR FUTURE REFERENCE.

CAUTION

THIS PRODUCT SHOULD BE INSTALLED ONLY BY A LICENSED ELECTRICIAN. PLEASE WEAR GLOVES TO PROTECT THE FINISH OF THE FIXTURE.

WARNING

THE ELECTRICITY MUST BE TURNED OFF AT THE MAIN FUSE BOX BEFORE INSTALLING THIS LUMINAIRE. TURNING POWER OFF USING THE LIGHT SWITCH MAY NOT BE SUFFICIENT TO PREVENT ELECTRICAL SHOCK.

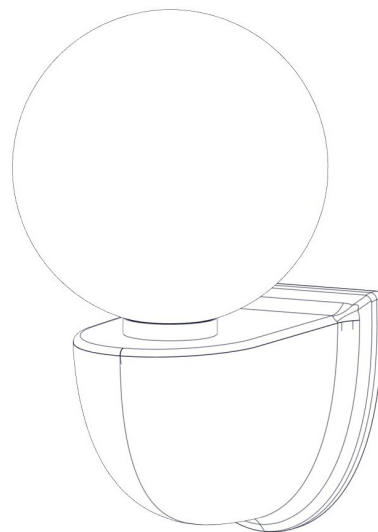

COMPONENTS PROVIDED FOR INSTALLATION

FIXTURE BODY	GLASS	ELECTRICAL	GLASS CUP	HEX WRENCH
BUTTON HEAD SCREW	BULB	JUNCTION BOX SCREWS	WIRE NUTS (X2)	



SAILOR V.2

ASSEMBLY AND MOUNTING INSTRUCTIONS

UE-2401

MOUNTING INSTRUCTIONS - 1 PERSON INSTALL

STEP 1

SHUT OFF THE MAIN ELECTRICAL SUPPLY TO THE JUNCTION BOX FROM THE FUSE BOX/CIRCUIT BREAKER. TURNING POWER OFF AT THE SWITCH IS NOT SUFFICIENT.

STEP 2

LOOSEN SET SCREW AT BASE OF FIXTURE BODY WITH PROVIDED HEX WRENCH AND REMOVE MOUNTING PLATE.

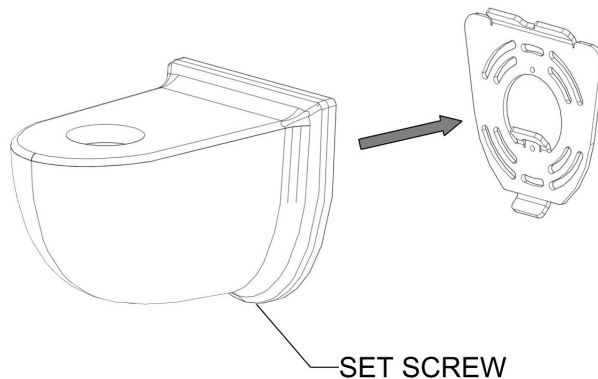

STEP 3

LOCATE JUNCTION BOX AND PULL HOUSE SUPPLY WIRE THROUGH THE WIRE-WAY OF THE MOUNTING PLATE. ATTACH MOUNTING PLATE TO JUNCTION BOX WITH JUNCTION BOX SCREWS. CHECK LEVEL ON MOUNTING PLATE

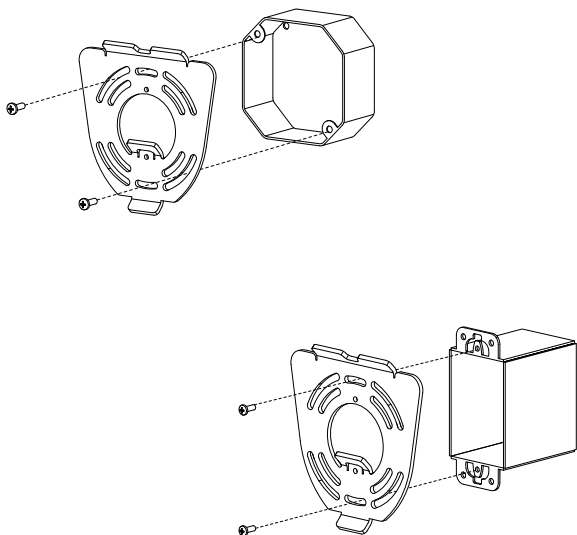

STEP 4

INSTALL GLASS CUP ONTO FIXTURE BODY. FEED WIRE FROM ELECTRICAL THROUGH FIXTURE BODY AND OUT THROUGH THE BACK. SCREW DOWN NIP AT BASE OF ELECTRICAL INTO FIXTURE BODY.

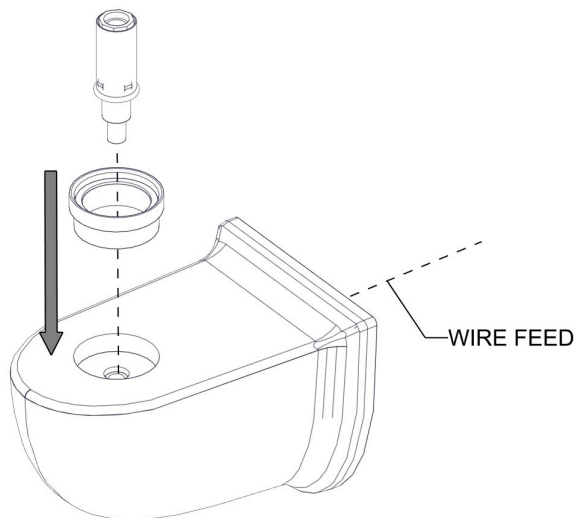



SAILOR V.2

ASSEMBLY AND MOUNTING INSTRUCTIONS

UE-2401

STEP 5

ATTACH SAFETY CABLE TO MOUNTING PLATE WITH BUTTON HEAD SCREW.

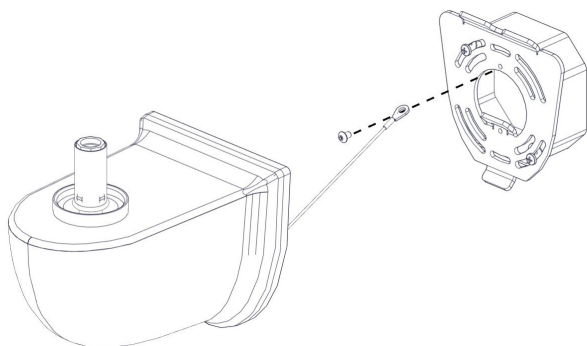

STEP 6

USING THE WIRE NUTS PROVIDED, MAKE ELECTRICAL CONNECTIONS BY FOLLOWING THE ELECTRICAL CONFIGURATION TABLE BELOW. ENSURE THAT ALL ELECTRICAL CONNECTIONS ARE WRAPPED WITH UL-LISTED ELECTRICAL TAPE.

IMPORTANT: NEVER ALLOW FIXTURE TO “HANG” FROM ELECTRICAL CONNECTIONS OR TO OTHERWISE PUT PRESSURE ON THE CONNECTIONS. THE WEIGHT OF THE FIXTURE SHOULD BE SUPPORTED BY THE MOUNTING ASSEMBLY.

STEP 7

ATTACH FIXTURE TO THE WALL BY SLIPPING IT OVER THE MOUNTING PLATE AND TIGHTENING SET SCREW. BE CAREFUL TO AVOID SCRATCHING THE FINISH.

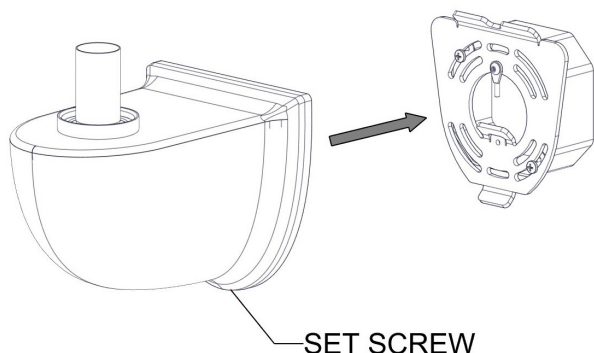

STEP 8

INSTALL BULB AND GLASS. RETURN POWER TO CIRCUIT, CONFIRM OPERATION OF FIXTURE.

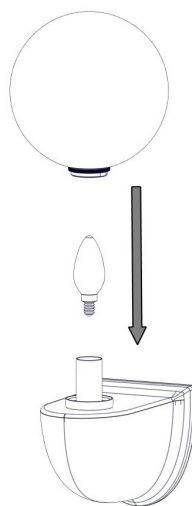

ELECTRICAL CONFIGURATION TABLE

FROM HOME	FROM LUMINAIRE
CONNECT BLACK OR RED (HOT) HOUSE SUPPLY CIRCUIT WIRE TO:	LUMINAIRE ROUND/BLACK WIRE (HOT)
CONNECT WHITE (NEUTRAL) HOUSE SUPPLY CIRCUIT WIRE TO:	LUMINAIRE RIBBED/WHITE WIRE (NEUTRAL)
CONNECT GREEN INSULATED OR BARE COPPER (GROUND -) HOUSE SUPPLY CIRCUIT WIRE AND LUMINAIRE BARE STRANDED WIRE (GROUND -) TO GREEN GROUND SCREW ON CROSSBAR.	

GENERAL NOTE: USE UL LISTED WIRE NUTS FOR THE WIRING CONNECTIONS IN THIS LUMINAIRE. WRAP WIRE NUT CONNECTIONS WITH UL LISTED ELECTRICAL TAPE.

FOR QUESTIONS, PLEASE CONTACT CLIENT SERVICES AT: 843.723.8140 OR
INFO@URBANELECTRICCO.COM