



GALLERY

ASSEMBLY AND MOUNTING INSTRUCTIONS

UE-2154

GENERAL NOTES

- THIS LUMINAIRE IS SUITED FOR DAMP LOCATIONS.
- THIS LUMINAIRE IS UL LISTED. WHEN INSTALLING LUMINAIRE, CONFORM TO ALL APPLICABLE LOCAL ELECTRICAL CODES, ORDINANCES, AND THE NATIONAL ELECTRICAL CODE (NEC).
- FOR YOUR SAFETY AND PROPER OPERATION OF LUMINAIRE, READ AND UNDERSTAND ALL INSTRUCTIONS COMPLETELY BEFORE COMMENCING INSTALLATION OF THIS LUMINAIRE.
- CAREFULLY UNPACK THE LUMINAIRE AND INSPECT FOR DAMAGE.
- THIS PRODUCT IS RATED FOR TWO 25W MAX TYPE B BULBS.
- SAVE THESE INSTRUCTIONS FOR FUTURE REFERENCE.

CAUTION

THIS PRODUCT SHOULD BE INSTALLED ONLY BY A LICENSED ELECTRICIAN.

WARNING

THE ELECTRICITY MUST BE TURNED OFF AT THE MAIN FUSE BOX BEFORE INSTALLING THIS LUMINAIRE. TURNING POWER OFF USING THE LIGHT SWITCH MAY NOT BE SUFFICIENT TO PREVENT ELECTRICAL SHOCK.

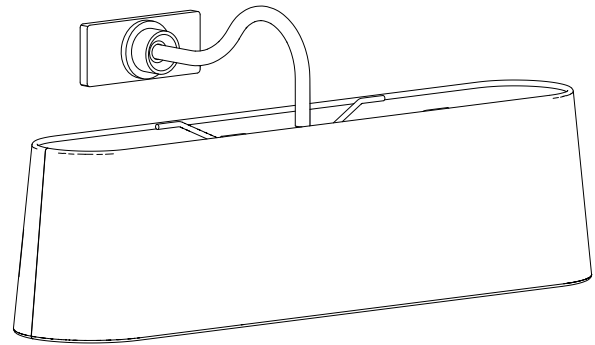

COMPONENTS PROVIDED FOR INSTALLATION

FIXTURE BODY	SHADE	DIFFUSER	WIRE NUT (2X)	BULB (X2)	DRYWALL ANCHOR (X2)
HEX WRENCH	BACK PLATE EXTENSION (OPTIONAL)	BACK PLATE EXTENSION (OPTIONAL)	BACK PLATE EXTENSION (OPTIONAL)	JUNCTION BOX SCREWS (X2)	



GALLERY

ASSEMBLY AND MOUNTING INSTRUCTIONS

UE-2154

MOUNTING INSTRUCTIONS

STEP 1

SHUT OFF MAIN ELECTRICAL SUPPLY TO JUNCTION BOX FROM FUSE BOX/CIRCUIT BREAKER. TURNING POWER OFF AT SWITCH IS NOT SUFFICIENT.

STEP 2

USE HEX WRENCH PROVIDED TO LOOSEN SET SCREW AT BOTTOM OF FIXTURE AND REMOVE MOUNTING PLATE FROM BACK OF FIXTURE BODY.

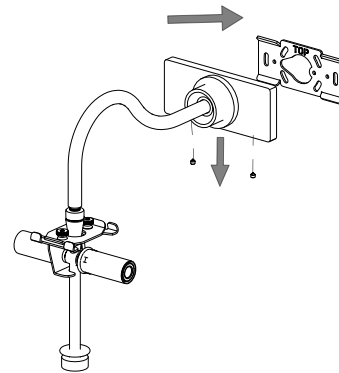

STEP 3

PULL HOUSE SUPPLY CIRCUIT WIRING THROUGH WIRE-WAY OF MOUNTING PLATE. ATTACH MOUNTING PLATE TO JUNCTION BOX USING JUNCTION BOX SCREWS.

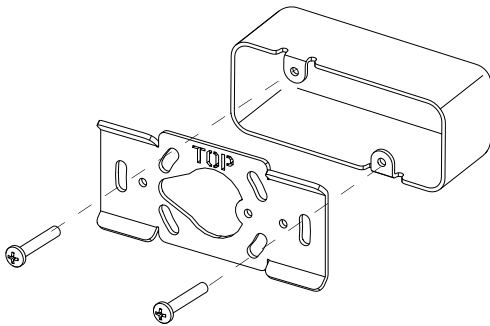

STEP 3.2

IF USING A SINGLE GANG JUNCTION BOX, USE THE APPROPRIATE BACKPLATE EXTENSION.

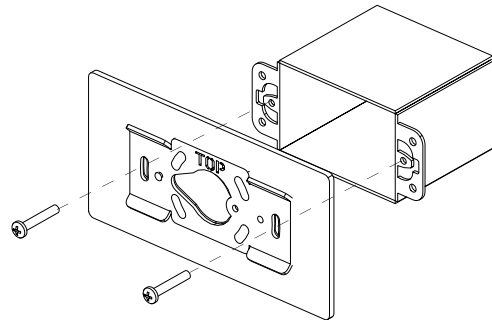

STEP 3.3

IF USING AN OCTAGONAL JUNCTION BOX, USE THE APPROPRIATE BACKPLATE EXTENSION. MOUNT WITH DRYWALL ANCHORS PROVIDED.

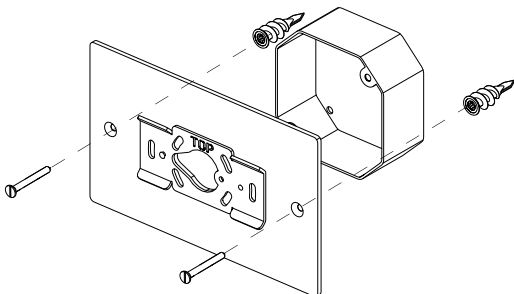

STEP 4

LIFT FIXTURE BODY TO WALL. USING WIRE NUTS PROVIDED, MAKE ELECTRICAL CONNECTIONS BY FOLLOWING ELECTRICAL CONFIGURATION TABLE PROVIDED. ENSURE ALL ELECTRICAL CONNECTIONS ARE WRAPPED WITH UL-LISTED ELECTRICAL TAPE



GALLERY ASSEMBLY AND MOUNTING INSTRUCTIONS

UE-2154

STEP 5

ATTACH FIXTURE BODY TO WALL BY SLIPPING IT OVER MOUNTING PLATE AND TIGHTENING SET SCREWS.

ALSO REMOVE DIFFUSER CAP AND SET ASIDE.

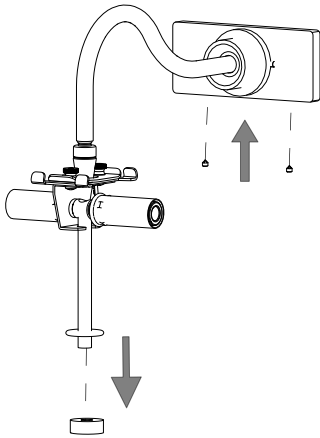

STEP 6

INSTALL BULBS.

REMOVE THUMB NUTS AND SET ASIDE.

LIFT SHADE BRACKET OUT OF THE WAY.

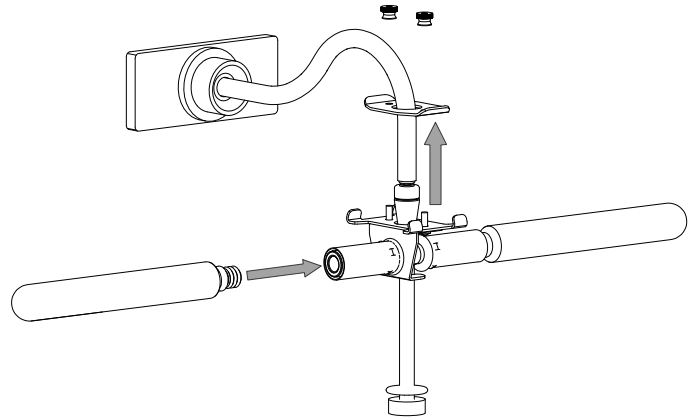

STEP 7

INSTALL SHADE.

BE SURE SHADE IS CENTERED ON BRACKET.

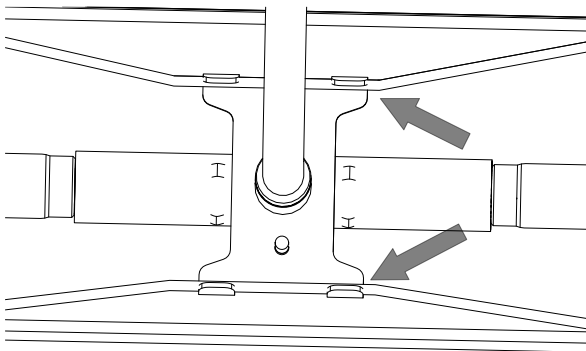

STEP 8

REPLACE SHADE BRACKET AND SECURE WITH THUMB NUTS.

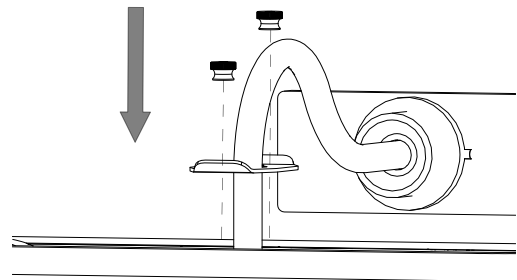



GALLERY ASSEMBLY AND MOUNTING INSTRUCTIONS

UE-2154

STEP 9

INSTALL DIFFUSER.

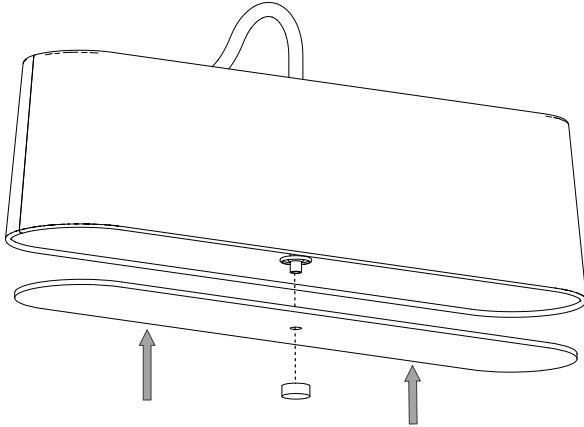

STEP 10

RESTORE POWER TO CIRCUIT AND CONFIRM PROPER OPERATION OF FIXTURE.

ELECTRICAL CONFIGURATION TABLE

FROM HOME	FROM LUMINAIRE
CONNECT BLACK OR RED (HOT) HOUSE SUPPLY CIRCUIT WIRE TO:	LUMINAIRE ROUND/BLACK WIRE (HOT)
CONNECT WHITE (NEUTRAL) HOUSE SUPPLY CIRCUIT WIRE TO:	LUMINAIRE RIBBED/WHITE WIRE (NEUTRAL)
CONNECT GREEN INSULATED OR BARE COPPER (GROUND -) HOUSE SUPPLY CIRCUIT WIRE AND LUMINAIRE BARE STRANDED WIRE (GROUND -) TO GREEN GROUND SCREW ON MOUNTING PLATE.	

GENERAL NOTE: USE UL LISTED WIRE NUTS FOR THE WIRING CONNECTIONS IN THIS LUMINAIRE. WRAP WIRE NUT CONNECTIONS WITH UL LISTED ELECTRICAL TAPE.

FOR QUESTIONS, PLEASE CONTACT CLIENT SERVICES AT:

843.723.8140 OR INFO@URBANELECTRIC.COM